



Windrush, Highworth, SN6 7DX

£240,000
(Subject to Contract)

Hanley's

Windrush Highworth SN6 7DX

A well presented three bedroom terraced house situated on this popular development with far reaching view to the front and a private southerly facing rear garden. The property has been updated by the current owners and offers accommodation comprising: hall, living room/ dining room, fitted kitchen with integrated oven and hob, to the first floor: landing with airing cupboard, access to the loft area, bathroom with shower over the bath and three bedrooms; one with fitted wardrobes. Outside are well tended gardens, the front with lawn and path to the front door and to the rear an enclosed southerly facing garden with patio area, steps to lawn with flower beds. A garden gate gives rear access leading to the single garage which is located close-by in a block. Further benefits include gas fired radiator central heating and double glazing. Windrush is situated within a short walk of local schools, doctors, shops and Pentylands Country Park.



1 Bathroom



3 Bedrooms



1 Reception

EPC: C 70

Council Tax Band: B

Tenure: Freehold



DISCLAIMER. These particulars, whilst believed to be accurate are set out as a general outline for guidance and do not constitute any part of an offer or contract. Intending purchasers should not rely on them as statements or representation of fact, but must satisfy themselves by inspection or otherwise as to their accuracy. No person in this firm's employment has the authority to make or give any representation or warranty in respect of the property. Floor plan measurements and distances are approximate only. We have not carried out a detailed survey nor tested the services, appliances or specific fittings. Your home is at risk if you do not keep up repayments on a mortgage or other loan secured on it.

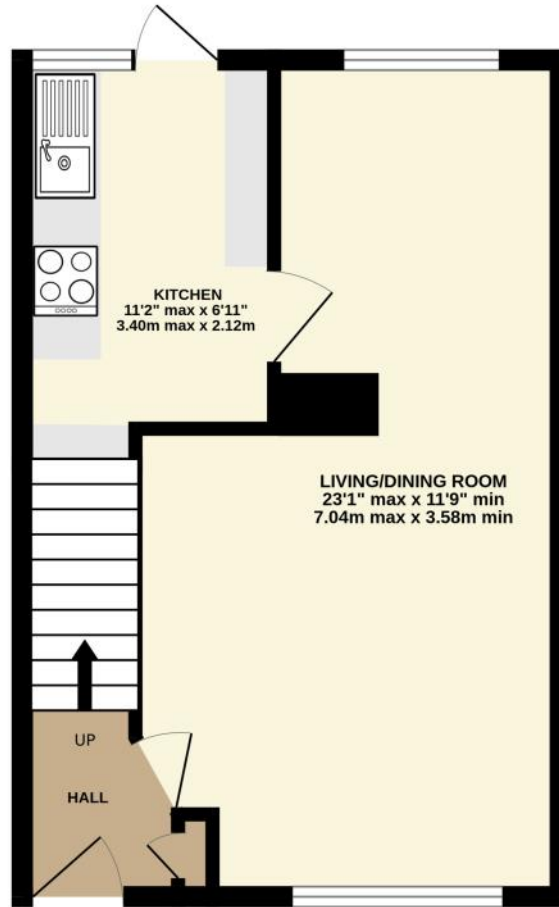

Hanley's

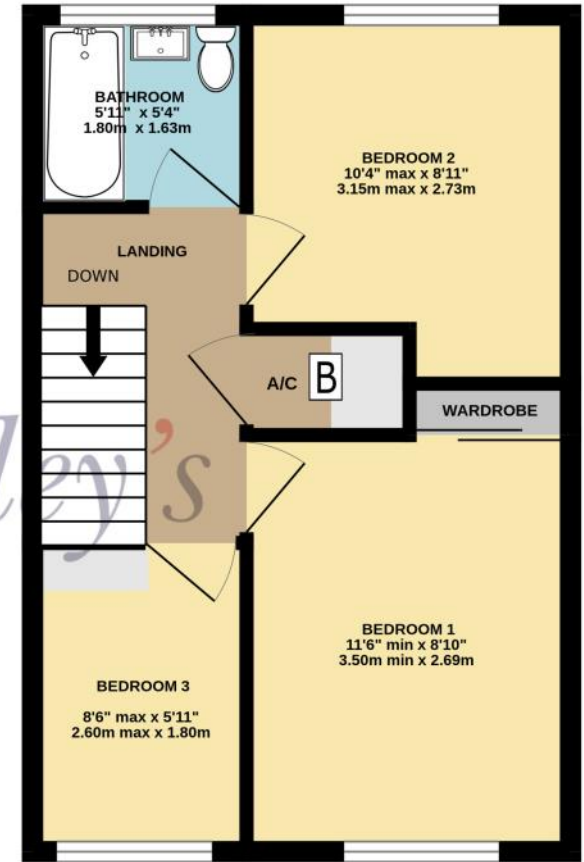

TOTAL FLOOR AREA : 681 sq.ft. (63.3 sq.m.) approx.

Whilst every attempt has been made to ensure the accuracy of the floorplan contained here, measurements of doors, windows, rooms and any other items are approximate and no responsibility is taken for any error, omission or mis-statement. This plan is for illustrative purposes only and should be used as such by any prospective purchaser. The services, systems and appliances shown have not been tested and no guarantee as to their operability or efficiency can be given.
Made with Metropix ©2024

Hanley's Estate Agents
25 High Street, Highworth, SN6 7AG
Tel: 01793 762005 mail@hanleys.co.uk

