



Windsor Road, Swindon, SN3 1LA

£575,000  
(Subject to Contract)

*Hanley's*



# Windsor Road Swindon SN3 1LA

An impressive four bedroom detached property set on a corner plot in this sought after location with local shops, doctors surgery and schools close-by. The property has been extend an updated with the spacious and well presented accommodation comprising: Entrance hall, living room, dining room with patio doors to the rear garden, large reception room, fitted kitchen/breakfast room with built-in oven, hob and dishwasher, utility room, downstairs cloakroom. To the first floor there is a large master bedroom with en-suite shower room, three further bedrooms and family bathroom. Gas central heating and double glazing. Outside there is a block paved driveway with parking for several vehicles leading to the attached double garage with door to the attractive rear garden. The property is offered for sale with NO ONWARD CHAIN.



**2 Bathrooms**



**4 Bedrooms**



**3 Receptions**

**EPC: D 68**

**Council Tax Band: E**

**Tenure: Freehold**



**DISCLAIMER.** These particulars, whilst believed to be accurate are set out as a general outline for guidance and do not constitute any part of an offer or contract. Intending purchasers should not rely on them as statements or representation of fact, but must satisfy themselves by inspection or otherwise as to their accuracy. No person in this firm's employment has the authority to make or give any representation or warranty in respect of the property. Floor plan measurements and distances are approximate only. We have not carried out a detailed survey nor tested the services, appliances or specific fittings. Your home is at risk if you do not keep up repayments on a mortgage or other loan secured on it.

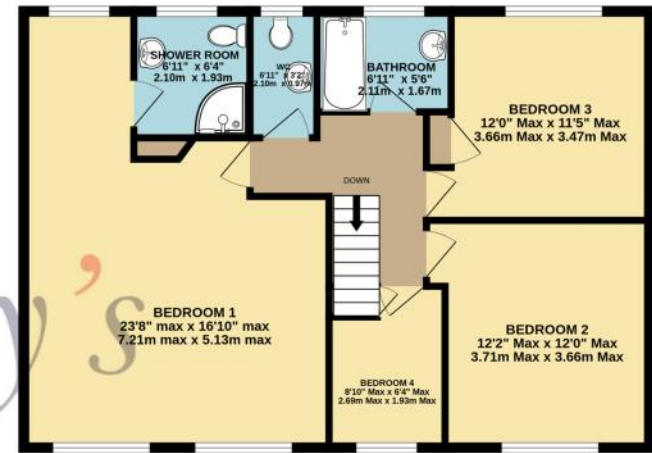

TOTAL FLOOR AREA : 2081 sq.ft. (193.3 sq.m.) approx.

Whilst every attempt has been made to ensure the accuracy of the floorplan contained here, measurements of doors, windows, rooms and any other items are approximate and no responsibility is taken for any error, omission or mis-statement. This plan is for illustrative purposes only and should be used as such by any prospective purchaser. The services, systems and appliances shown have not been tested and no guarantee as to their operability or efficiency can be given.  
Made with Metropix ©2024



Hanley's Estate Agents  
25 High Street, Highworth, SN6 7AG  
Tel: 01793 762005    mail@hanleys.co.uk







